

| | |
|-------------------|--|
| Project: | |
| Type: | |
| Catalog #: | |

STANDARD | OPTIONAL



ILLUMINATION

- Adjustable ultra bright 8W bi-pin halogen or 1.5W LED lamp head.
- Sealed beam PAR36-type gimbal trim with smooth chrome-plated metallized reflector and plastic lens offers optimal light distribution.

ELECTRICAL

- Dual 120/277 voltage.
- Charge rate/power "ON" LED indicator light and push-to-test switch for mandated code compliance testing.
- LVD (low voltage disconnect) prevents battery from deep discharge.
- 6V maintenance-free, rechargeable sealed lead acid battery.
- Internal solid-state transfer switch automatically connects the internal battery to lamp head for minimum 90-minute emergency illumination.
- Fully automatic solid-state, two rate charger initiates battery charging to recharge a discharged battery in 24 hours.

MOUNTING

- Compatible with drop ceiling mount installations. Bar hangers included.

HOUSING

- Steel mounting frame and housing.
- 6" recessed housing with mounting bar hangers.
- Impact-resistant thermoplastic adjustable gimbal trim.
- Junction box with 3/4" knockouts for AC input.
- Trim securely attached to housing with spring clips.

WARRANTY / LISTING

- Five year warranty on all electronics and housing. Battery prorated for two years.
- Meets UL924, NFPA 101 Life Safety Code, NEC, OSHA, Local and State Codes.
- UL Listed for dry locations.

DIMENSIONS

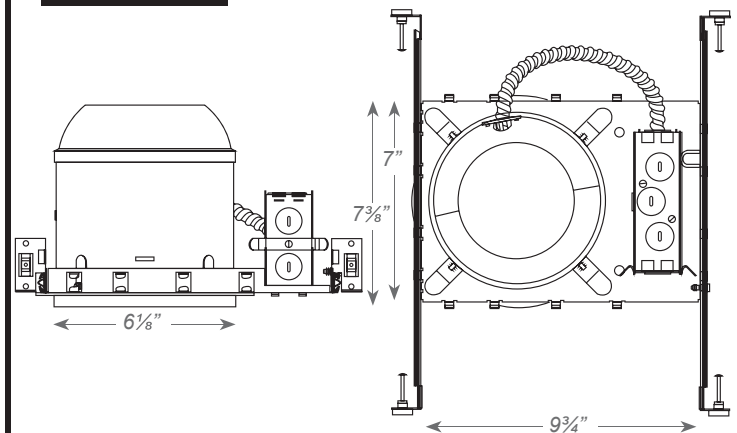

ORDERING INFORMATION

Sample Part Number: **ECO-EMRL-1-WHT-GIMBAL**

| MODEL | HOUSING COLOR | | | LAMP | |
|------------|---------------|-------|--------|---------|------------------------|
| ECO-EMRL-1 | WHT | White | GIMBAL | (blank) | 8W BI-PIN HALOGEN LAMP |
| | BLK | Black | | LED | 1.5W LED LAMP |

| | |
|-------------------|--|
| Project: | |
| Type: | |
| Catalog #: | |

ELECTRICAL INFORMATION

| CATALOG NUMBER | INPUT WATTS (W) | | INPUT AMPS (A) | |
|----------------|-----------------|------|----------------|------|
| | 120V | 277V | 120V | 277V |
| ECO-EMRL-1 | 8.0 | 8.0 | 0.05 | 0.05 |