

Project:	
Type:	
Catalog #:	

STANDARD



OPTIONAL



-NH model

ILLUMINATION

- Long lasting, efficient ultra bright white LED lamp heads.
- 1 watt (8 LEDs x 0.125W) per head.
- High performance chrome-plated metallized reflector and plastic lens for optimal light distribution.
- Adjustable LED lamp heads provides optimal center-to-center spacing. Optional high-lumen heads are available for increased center-to-center spacing.
- Long life, energy efficient Red or Green LED EXIT sign illumination.

ELECTRICAL

- Dual 120/277 voltage.
- Charge rate/power "ON" LED indicator light and push-to-test switch for mandated code compliance testing.
- 9.6V Long life, maintenance-free, rechargeable NiCd battery.
- Internal solid-state transfer switch automatically connects the internal battery to LED board and LED lamp heads for minimum 90-minute emergency illumination.
- Fully automatic solid-state, two rate charger initiates battery charging to recharge a discharged battery in 24 hours.
- Remote capacity option available.

MOUNTING

- EZ-snap mounting canopy included for top or end mount.
- Universal K/O pattern on back plate for wall mount.

HOUSING

- Injection-molded, engineering grade, 5VA flame retardant, high-impact resistant, thermoplastic in white or black finish.
- EZ snap-out chevron directional indicators.

OPTIONS

- HL: 12-LED heads provide increased center-to-center spacing (1.5W per head).
- SDT: Self-diagnostic feature performs monthly, biannual, and annual tests to ensure reliable operation and meet electrical and life safety codes.
- NH: No lamp head attached to the unit enabling it to be used as remote capable exit sign.
- Custom: Signs available with requested 'special' wording.
- USA: Substantial transformation assembly in U.S. complies with "Assembled in USA" under the Buy American Act.

WARRANTY / LISTING

- Five year warranty on all electronics and housing. Battery pro rated for five years.
- Meets UL924, NFPA 101 Life Safety Code, NEC, OSHA, Local and State Codes.
- UL Listed for damp locations (0°C – 40°C).
- Certified to CEC under Title 20 Regulations.

DIMENSIONS

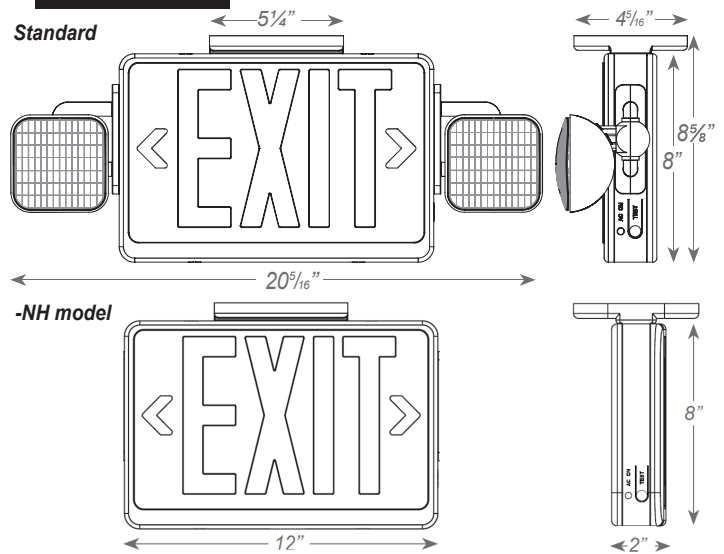

ORDERING INFORMATION

Sample Part Number: ECO-LEDCXTEU-2-R-W

Special voltage & SALIDA face plate options available. Check with your Best Lighting Representative.

MODEL	No. of FACES	LETTER COLOR	HOUSING COLOR	OPTIONS
ECO-LEDCXTEU	2 Universal Single/ Double Face	R Red	W White	RC Remote Capacity
		G Green	B Black	HL High Lumen
				NH No Lamp Heads
				SDT Self-diagnostics
				CUSTOM Custom Wording
				USA Assembled in USA

Project:	
Type:	
Catalog #:	

ELECTRICAL INFORMATION

CATALOG NUMBER	INPUT WATTS (W)		INPUT AMPS (A)	
	120V	277V	120V	277V
ECO-LEDCXTE-RED	3.7	3.8	0.040	0.020
ECO-LEDCXTE-GREEN/RC	3.0	3.2	0.030	0.014
ECO-LEDCXTE-RED-RC	3.4	3.6	0.033	0.015
ECO-LEDCXTE-RED/GREEN-SDT/RC-SDT	5.2	5.7	0.046	0.022

REMOTE LAMP COMPATIBILITY

MODEL NUMBER	BATTERY	REMOTE CAPACITY	COMPATIBLE REMOTE HEAD FAMILY												
			MRHLED	RHLED	RH16LED	RH16		RH		RHR		SRH		SRHLED	
				MV		6V	12V	6V	12V	6V	12V	6V	12V		
ECO-LEDCXTEU-RC	9.6V	3W-4W		X	X										
ECO-LEDCXTEU-NH	9.6V	3W		X	X										
ECO-LEDCXTEU-RC-NH	9.6V	6W		X	X										